

SACKVILLE  
GARDENS

GARDEN FLAT  
ONE BEDROOM

Charming,  
bright and  
airy..



NASHWATSON

beautifully imperfect since 2009

## **SACKVILLE GARDENS GARDEN FLAT**

Set inside a Victorian house a one-bedroom ground floor garden flat. The flat has a westerly facing living room, a separate kitchen, a bathroom, and a bedroom that accesses a tranquil rear garden. This is a charming, bright and airy living space with stylish, understated, grown-up decor. Sash windows, wooden floorboards and a marble fireplace provide a perfect backdrop for a serene, modern and minimalist lifestyle.

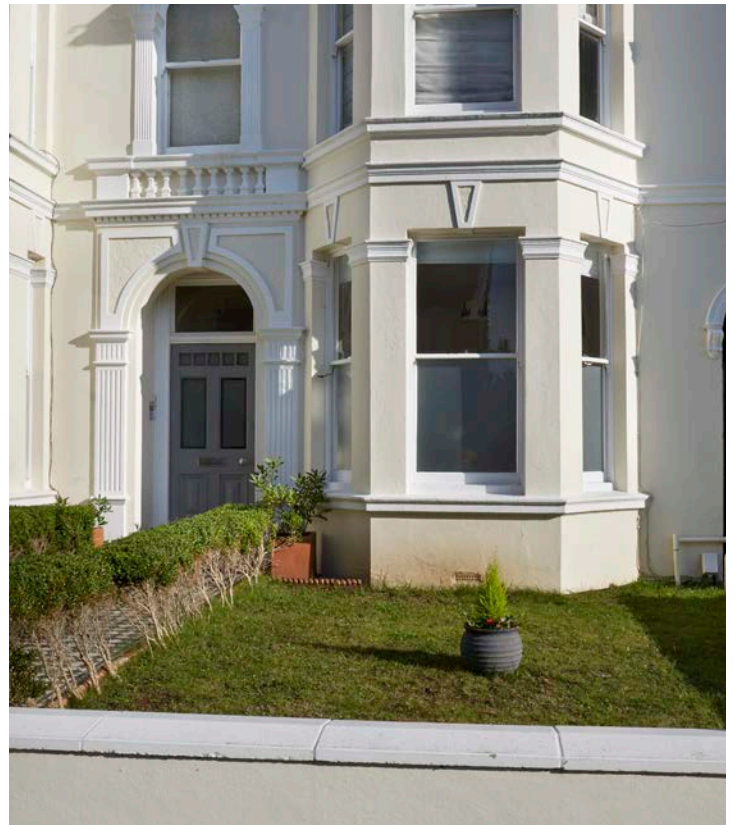



**SACKVILLE GARDENS  
GARDEN FLAT  
1 BEDROOM**



NASH WATSON  
 69 A&B CHURCH ROAD  
 HOVE  
 BN3 2BB  
 01273 733 500  
 HOME@NASHWATSON.COM

SACKVILLE GARDENS

GARDEN FLAT 1 BEDROOM

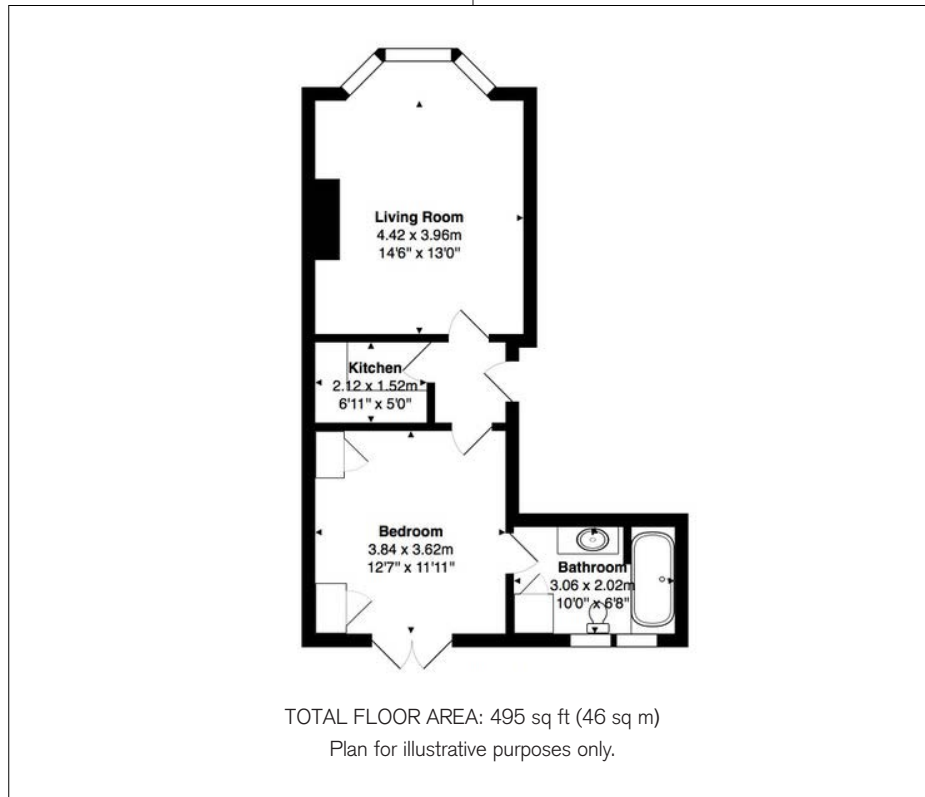

BLUEPRINT..

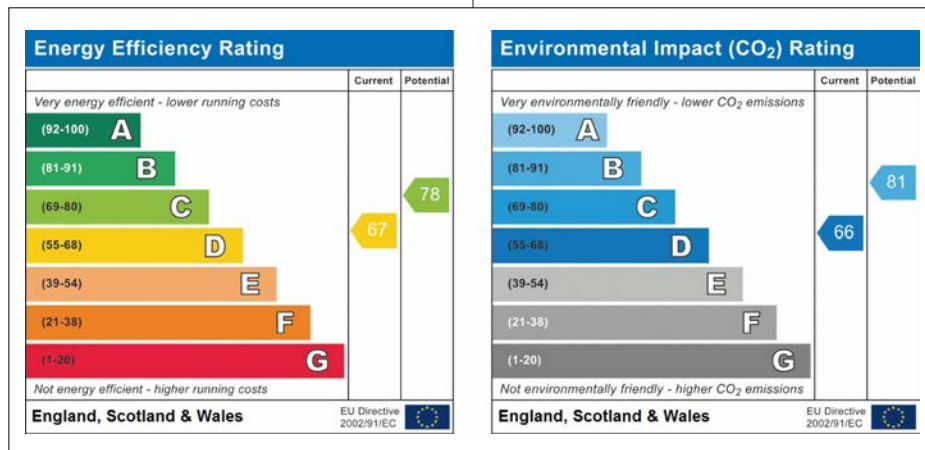

ENERGY PERFORMANCE GRAPH..

The particulars we have prepared in this brochure are just a guide. No survey has been carried out and room sizes are approximate. Whilst we take reasonable care to ensure its accuracy, we cannot guarantee this and do not supply any warranty or representation of any kind in relation to the content herein.

Our redress scheme is The Property Ombudsman [www.tpos.co.uk](http://www.tpos.co.uk) Nash Watson Ltd have client money protection insurance provided by Client Money Protect Membership number: CMP003294 [www.clientmoneyprotect.co.uk](http://www.clientmoneyprotect.co.uk)

Nash Watson Ltd trading as 'Nash Watson' is a company registered in England. Registration number: 6913269. Registered Offices: (no correspondence please) 23 St Leonards Road, Bexhill On Sea, East Sussex, TN40 1HH.

